

Water Tanks - Rainwater Management Systems

Delivery Considerations

1. We require clear drivable access through roads, gates, crossings, roundabouts and trees to and at your property.
2. If clear access to the site is not available for the delivery vehicle, the tank will be unloaded and left at the point where clear access terminates.
3. Delivery responsibilities cease when the tank is placed on the site where clear access permits.
4. Delivery drivers will not roll tanks further than the unload point (where clear access ends).
5. Securing of the tank after it has been unloaded and prior to its installation is the customer's responsibility.
6. Tank delivery drivers will not assist in the placement of the tank onto bases, concrete slabs or stands.
7. Weather permitting (wind/rain).

Rainwater Tank Installation Guide

1. The tank stand (base) must be stable, firm, flat, compacted and free from any rocks, stones or sharp objects.
2. The tank stand (base) must be larger than the tank diameter and able to fully support the tank.
3. If sand, crusher dust, or other consolidated fill is used as the stand (base), it is to be a minimum of 75mm in thickness and a supporting wall is to be used around it to prevent erosion.
4. Tank stand (base) must be able to safely support the tank when full of water, bearing in mind water weighs 1kg per litre.
5. A reinforced concrete stand (base) is ideal but must also be greater than the diameter of the tank.
6. The overflow of the tank must be piped at least 2 metres clear of the tank to avoid undermining of the tank stand (base).
7. All corstrip must be removed from the tank after installation.



Aquaplate, Colorbond, Galvanised, Corstrip & Bluescope are all registered trademarks of Bluescope Steel Limited.

Metroll Newcastle
ABN 97 001 446 439
268 Macquarie Road
WARNERS BAY NSW 2282
AUSTRALIA

P: +61 (0)2 4954 5799
F: +61 (0)2 4954 0891
www.metrollnewcastle.com.au
enquiries@metrollnewcastle.com.au

Water Tanks - Rainwater Management Systems

IF THESE GUIDELINES ARE NOT FOLLOWED, WARRANTY IS NULL AND VOID

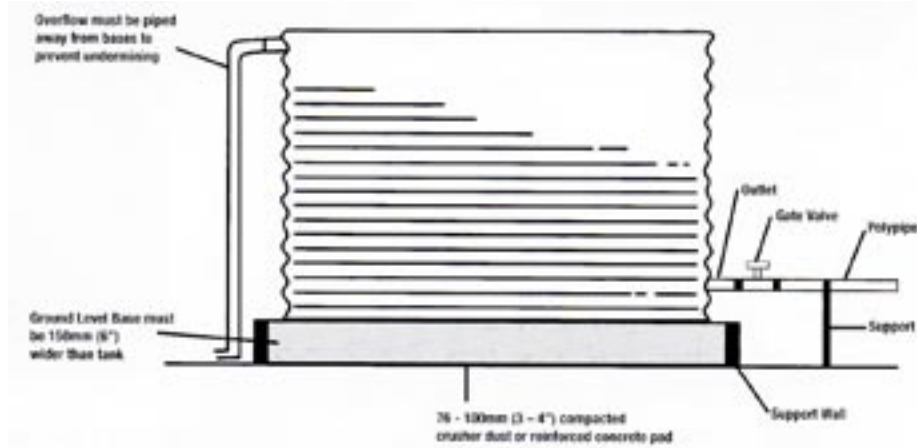

THESE ERRORS WILL VOID YOUR WARRANTY
[Don't leave a tank empty as it will blow away!]

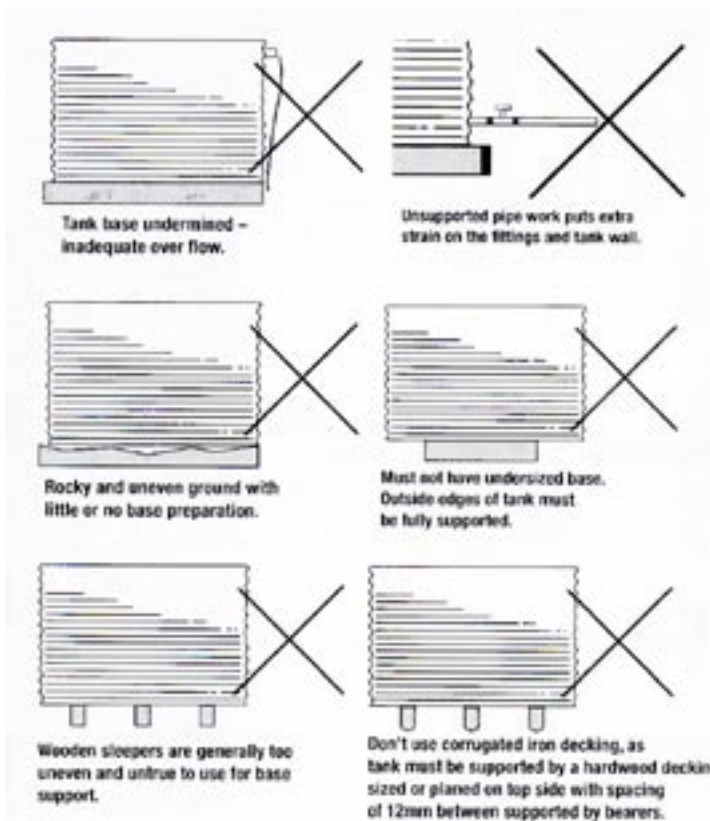

Metroll Newcastle
 ABN 97 001 446 439
 268 Macquarie Road
 WARNERS BAY NSW 2282
 AUSTRALIA

P: +61 (0)2 4954 5799
 F: +61 (0)2 4954 0891
www.metrollnewcastle.com.au
enquiries@metrollnewcastle.com.au